

09F3 COMPACT TRACTOR

JUNE 1983 TO FEB 1986. CREAM AND GREY. 11HP 28" CUT. LONG FLAT DISENGAGEMENT LEVER, THREADED DISENGAGING ADJUSTER. KEY START. CHAIN ADJUSTER. RUBBER BONNET STRAPS. CENTRE WEIGHT COMPENSATING SPRING. CAST IRON CLUTCH ARM.

09B6 COMPACT TRACTOR

FEB 1986 TO SEPT 1986. CREAM AND GREY 11HP 28" CUT OR BLACK 12HP TECUMSEH 28" CUT. BLACK STEERING WHEEL WITH CHROME CENTRE. MOULDED SEAT.

09J6 COMPACT TRACTOR

SEPT 1986 TO DEC 1987. MICRO SWITCHES. METAL BONNET HOOKS WITH SPRINGS. HEAVIER DISENGAGING ADJUSTER THREADED AND BUSHED PIECES (1/2").

09M7 COMPACT TRACTOR

DEC 1987 TO FEB 1990. LAST OF THE CREAM STYLE MACHINES. CLUTCH CHANGES INCORPORATING CLUTCH ADJUSTER PLATE AND TAPPED PLATE. IN DEC 1988 PLASTIC TYPE HEIGHT ADJUSTMENT BUTTON, BATTERY COVER, BONNET HOOKS, STEERING WHEEL ETC.



COMPACT TRACTORS 1983-1990 09F3 - 09B6 - 09J6 - 09M7

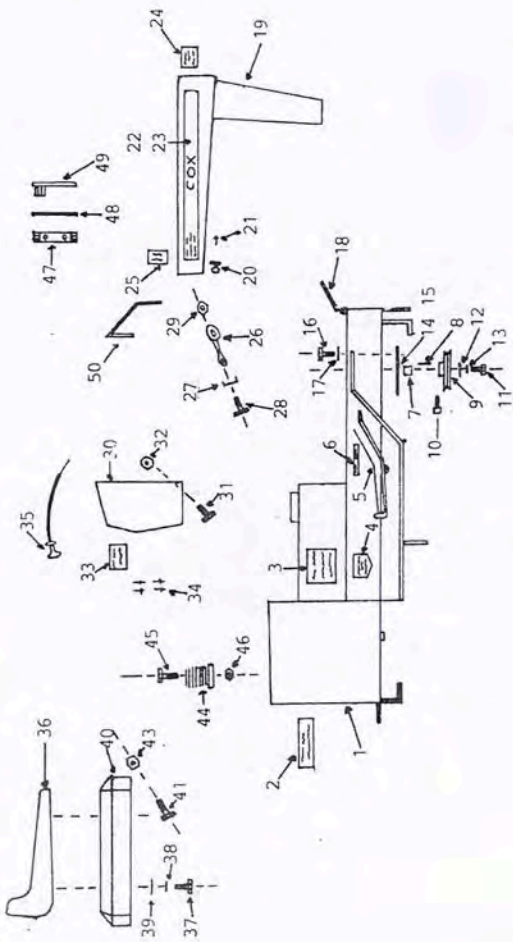

09F3 - 09B6 - 09J6 - 09M7 GROUP 11: CHASSIS & COMPONENTS

| Ref. No. | Part No. | Description |
|----------|-----------|---|
| 1 | 091101F3 | Chassis 09F3 NLA |
| | 091101B6 | Chassis 09B6 NLA |
| | 091101J6 | Chassis 09J6 NLA |
| | 091101M7 | Chassis 09M7 NLA |
| 2 | STR16 | Transfer "Cox" Rear Chassis |
| 3 | STR05 | Transfer - Chassis (11HP) (2) NLA |
| | STR26 | Transfer - Chassis (12HP) (2) 09B6 09J6 09M7 |
| 4 | STR27 | Transfer - Depress Switch to Start |
| 5 | NSM01 | Pedal Non Skid |
| 6 | STR28 | Transfer-Out CutterIn- 09B6 09J6 09M7 |
| 7 | AM233 | Engine Pulley Spacer |
| 8 | AM175 | Engine Pulley Key |
| 9 | AM234 | Engine Pulley (Cast Iron) |
| 10 | GS0505C | Engine Pulley Key Screw |
| 11 | SH0720F | Engine Pulley Retaining Bolt |
| 12 | W072004 | Engine Pulley Ret. Bolt Washer |
| 13 | W075 | Engine Pulley Ret Bolt S/P Washer |
| 14 | SAM077 | Engine Mounting Bolt Plate - 190mm LH NLA |
| 15 | AM078B0 | Engine Mounting Bolt Plate RH |
| 16 | B0524C | Engine Mounting Bolt (4) |
| 17 | W055 | Engine Mounting Bolt S/P Washer (4) |
| 18 | SAM210 | Bonnet Hinge Pin NLA |
| 19 | SKJT18B/C | Bonnet NLA |
| 20 | 091118K5 | Bonnet Strap Pillar (2) (rubber strap) NLA |
| | SAM178 | Bonnet Strap Pillar (2) NLA |
| 21 | PR0308 | Pillar Pop Rivet (2) |
| 22 | STR21 | Transfer - LH Bonnet Side NLA |
| 23 | STR22 | Transfer - RH Bonnet Side |
| 24 | STR23 | Transfer - Man. in Australia NLA |
| | AM153 | Bonnet Emblem NLA |
| 25 | STR18 | Transfer - Starting Caution 09B6 09J6 09M7 NLA |
| 26 | AM180 | Bonnet Spring (2) 09J6 09M7 |
| | 0911F311 | Bonnet Strap Clamp (2) 09F3 09B6 NLA |
| 27 | AM181 | Bonnet Strap (2) 09J6 09M7 |
| | 0911F310 | Bonnet Strap (2) 09F3 09B6 NLA |
| 28 | SH0412C | Bonnet Spring Bolt (2) |
| 29 | N04CN | Bonnet Spring Bolt Nut (2) |
| | W040816 | Bonnet Spring Washer (2) |
| 30 | S091112F3 | Dash Panel NLA |
| 31 | SH0412C | Dash Panel Mounting Bolt (4) |
| 32 | N04CN | Dash Panel Mounting Bolt Nut (4) |
| 33 | S091113 | Dash Panel Instruction Plate NLA |
| 34 | PR0207 | Dash Panel Instruction Plate Pop Rivet (4) |
| 35 | S091114 | Throttle Cable B&S and Honda NLA |
| | S091120B6 | Throttle Cable Tecumseh 09B6 09J6 09M7 NLA |
| 36 | AM164 | Seat 09B6 09J6 09M7 NLA |
| | AM001 | Seat 09F3 NLA |
| 37 | SH0512C | Seat Ret Bolt (4) 09B6 09J6 09M7 |
| 38 | W055 | Seat Ret Bolt S/P Washer (4) 09B6 09J6 09M7 |
| 39 | W052003 | Seat Ret Bolt Washer (4) 09B6 09J6 09M7 |
| 40 | S091117D9 | Transmission Housing Cover NLA |
| 41 | SH0516C | Transmission Cover Hinge Bolt (2) |
| 43 | N05CN | Transmission Hinge Bolt Nut (2) |
| 44 | AM177 | Seat Spring (2) |
| 45 | SH0616C | Seat Spring Ret Bolt (2) |
| 46 | N06CN | Seat Spring Ret Bolt Nut (2) |
| 47 | AM006C1 | Tube Spanner |
| 48 | AM007 | Tube Spanner Tommy Bar |
| 49 | AM005G0 | Spark Plug Spanner |
| 50 | AM179 | Bonnet Trim 09B6 09J6 09M7 |

NB For Honda Engine Only: SAM077 Engine Mtg. Plate LH **Not Used** B0524C Engine Mtg. Bolt (2) **Used**

Replaced By: SAM097 Engine Mounting Plate LH B0520F Engine Mounting Bolt (2) LH

09F3 - 09B6 - 09J6 - 09M7 GROUP 12: RIGHT SIDE OF CHASSIS

| Ref. No. | Part No. | Description |
|----------|-----------|--|
| 1 | AM238 | Clutch Rod Short |
| 2 | CP3-220 | Clutch Rod Short Split Pin |
| 3 | RP01 | Clutch Rod Short 'R' Pin |
| 4 | AM182E94 | Clutch Rod Pivot Plate 09B6 09J6 09M7 |
| | AM008*** | Clutch Rod Pivot Plate 09F3 NLA |
| 5 | W061216 | Clutch Rod Pivot Plate Washer |
| 6 | N06CN | Clutch Rod Pivot Plate Nut |
| 7 | S091202F3 | Clutch Rod Long |
| 8 | CP3-220 | Clutch Rod Long Split Pin (2) |
| 9 | W061216 | Clutch Rod Long Washer (2) |
| 10 | S091204D9 | Disengaging Handle 09B6 09J6 09M7 |
| | S091204F3 | Disengaging Handle 09F3 |
| 11 | AM335 | Handle Grip |
| 12 | B0624C | Disengaging Handle Pivot Bolt |
| 13 | W061216 | Disengaging Handle Pivot Bolt Washer (2) |
| 14 | N06C | Disengaging Handle Pivot Bolt Nut |
| 15 | N06CN | Disengaging Handle Pivot Bolt Locknut |
| 16 | AM240 | Disengaging Adjuster Bushed |
| 17 | SH0516C | Disengaging Adjuster Bolt |
| 18 | N06CN | Disengaging Adjuster Bolt Nut |
| 19 | AM010** | Disengaging Adjuster Threaded NLA 09F3 09B6 NLA |
| | AM010J6 | Disengaging Adjuster Threaded 09J6 09M7 |
| 20 | RP01 | Disengaging Adjuster 'R' Pin |
| 21 | W051216 | Disengaging Adjuster Washer (2) |

** Convert to 1/2" Thread using P/N AM010J6 & AM240

*** Use AM182E94

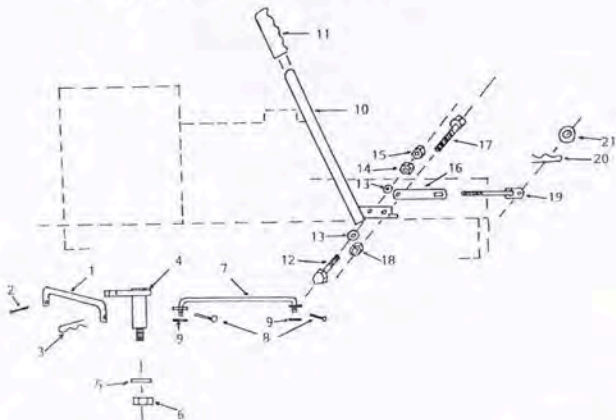

09F3 - 09B6 - 09J6 - 09M7 GROUP 13: LEFT SIDE OF CHASSIS

| Ref. No. | Part No. | Description |
|----------|-----------|--|
| 1 | 09L301 | Brake Pedal 09F3 NLA |
| | 09L302 | Brake Pedal Link 09F3 NLA |
| | SAM184 | Brake Pedal 09B6 09M7 NLA |
| 2 | S091306B6 | Brake Pedal Rack 09B6 NLA |
| | SAM187 | Brake Pedal Rack 09J6 09M7 |
| 3 | SH0516C | Brake Pedal Rack Bolt |
| 4 | N05CN | Brake Pedal Rack Bolt Nut |
| 5 | W061216 | Brake Pedal Split Pin Washer |
| 6 | CP3-220 | Brake Pedal Split Pin |
| 7 | AM183 | Brake Pedal Spring |
| 8 | NSM01 | Foot Rest Rubber |
| 9 | STR08 | Transfer Mounting Caution |
| 10 | AM143M9 | Height Adjustment Pawl Push Rod |
| 11 | AM012 | Height Adjustment Pawl Push Rod Spring |
| 12 | N04C | Height Adjustment Pawl Push Rod Locknut |
| 13 | AM013Q2 | Height Adjustment Pawl Push Rod Button |
| 14 | CP2-512 | Height Adjustment Pawl Push Rod Split Pin |
| 15 | AM011 | Height Adjustment Pawl |
| 16 | SH0516C | Height Adjustment Pawl Pivot Bolt |
| 17 | N06CN | Height Adjustment Pawl Pivot Bolt Nut |
| 18 | S091911D9 | Drive Chain Guard NLA |
| 19 | SH0412C | Drive Chain Guard Bolt (2) |
| 20 | N04CN | Drive Chain Guard Bolt Nut (2) |
| 21 | AM185B0 | Cutter Housing Lifting Link |
| 22 | N06CN | Cutter Lifting Link Nut |
| 23 | RP02 | Cutter Lifting Link 'R' Pin |
| 24 | AM186 | Front to Rear Connecting Rod NLA |
| 25 | B0620C | Front to Rear Connecting Rod Bolt (2) |
| 26 | N06CN | Front to Rear Connecting Rod Bolt Nut (2) |
| 27 | W061216 | Front to Rear Connecting Rod Bolt Washer (2) |
| 28 | AM034H0 | Cutter Brake Adjusting Bracket |
| 29 | SH0516C | Cutter Brake Adjusting Bracket Bolt |
| 30 | N05CN | Cutter Brake Adjusting Bracket Bolt Nut |
| 31 | 09L310 | Cutter Brake Adjusting Rod |
| 32 | AM035 | Cutter Brake Spring |
| 33 | NS05C | Cutter Brake Adjuster Rod Nut |
| 34 | W051216 | Cutter Brake Adjuster Rod Washer |
| 35 | RP01 | Cutter Brake Adjuster Rod 'R' Pin |

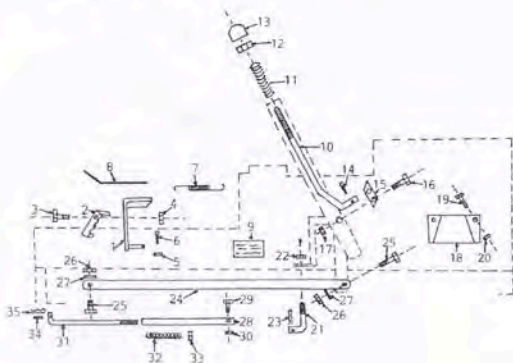

09F3 GROUP 14 : ELECTRICAL CIRCUIT

| Ref. No. | Part No. | Description |
|----------|-----------|---|
| 1 | AM014 | Ignibion Switch |
| | AM015 | Ignibion Key |
| 2 | AM159 | Solenoid |
| | SH0412C | Solenoid Mounting Bolt (2) |
| | N04CN | Solenoid Mounting Bolt Nut (2) |
| | AM300 | Battery Clamp (2) |
| | SR0420C | Battery Clamp Bolt |
| | N04C | Battery Clamp Bolt Nut |
| 3 | AM109 | Battery |
| | AM109CAP | Battery Caps |
| | AM098M8 | Battery Cover |
| 4 | SAM189 | Lead - Alternator to Battery Red Via Solenoid Red NLA |
| | S091416LB | Lead - (Honda only) Alternator to Battery Red Via Solenoid Red NLA |
| 5 | SAM188 | Lead - Switch Terminal (MAG) to Engine Cut out Switch NLA |
| 6 | 13115 | Lead - Solenoid Red (2) |
| 7 | 13116 | Lead - Solenoid Attach Bolt to Battery Negative Black |
| 8 | 13116 | Lead - Solenoid Attaching Bolt to Engine Cowl Black |
| 9 | 091417LB | Switch Socket Plus Wires NLA |
| 10 | S091408 | Lead - Switch Terminal (GRD) Earth Via Engine Cowl NLA |

FOR ELECTRIC START MACHINES

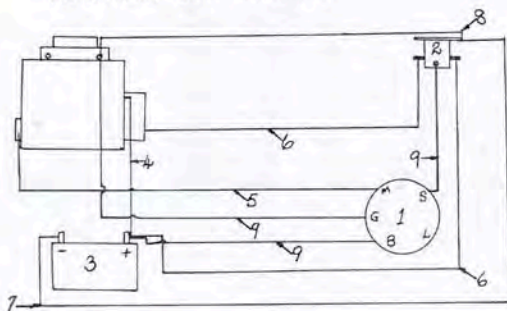

FOR MANUAL START MACHINES

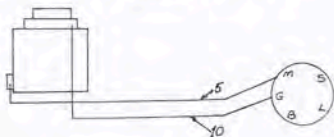

09B6 GROUP 14 : ELECTRICAL CIRCUIT

| Ref. No. | Part No. | Description | |
|----------|-----------|---|-----------------|
| 1 | AM109 | Battery | |
| | AM109CAP | Battery Caps | |
| | SH0412C | Battery Terminal Bolt (2) | |
| | N04C | Battery Terminal Bolt Nut (2) | |
| | AM300 | Battery Clamp (2) | |
| | SR0420C | Battery Clamp Bolt | |
| | N04C | Battery Clamp Bolt Nut | |
| | 2 | AM014 | Ignition Switch |
| | | AM015 | Ignition Key |
| | 3 | AM159 | Solenoid |
| SH0412C | | Solenoid Mounting Bolt (2) | |
| N04CN | | Solenoid Mounting Bolt Nut (2) | |
| 4 | 091417L8 | Switch Socket include Loom NLA | |
| | AM096 | Loom Clamp (3) | |
| | PR0308 | Loom Clamp Pop Rivet (3) | |
| 5 | SAM189 | Lead Alternator to Battery Red via Solenoid NLA | |
| | S091416L8 | Lead (Honda Only) Alternator to Battery via Solenoid NLA | |
| 6 | SAM188 | Lead Switch Terminal (Mag) to Engine Cut Out Switch NLA | |
| 7 | 13115 | Lead - Solenoid Wires - Red (2) | |
| | AM265 | Lead (Tecumseh Only) Solenoid | |
| 8 | 13116 | Lead - Solenoid Attaching Bolt to Battery Negative Black | |
| 9 | 13116 | Lead - Solenoid Attaching Bolt to Engine Cowl - Black | |
| | SAM099 | Front Micro Bracket NLA | |
| 10 | SH0412C | Front Micro Bracket Bolt (2) | |
| | N04CN | Front Micro Bracket Bolt Nut (2) | |
| 11 | AM092 | Micro Switch (2) | |
| | AM100R2 | Rear Micro Spring Plate | |
| | SH0412C | Rear Micro Spring Plate Bolt (2) | |
| | N04CN | Rear Micro Spring Plate Bolt Nut (2) | |
| | S091408 | Lead - Switch Terminal (Grd) Earth via Engine Cowl NLA | |
| | AM096M8 | Battery | |

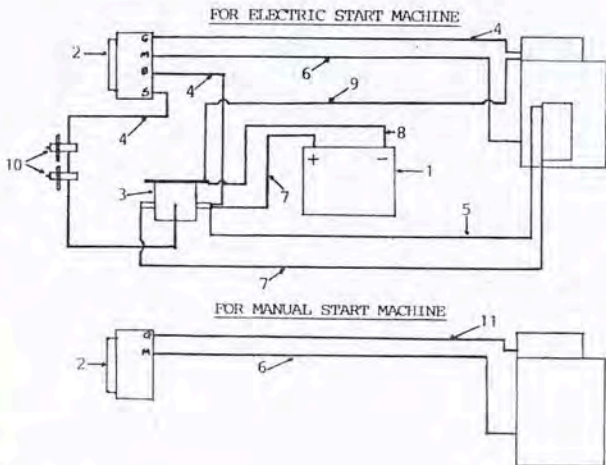

09J6 - 09M7 GROUP 14 : ELECTRICAL CIRCUIT

| Ref. No. | Part No. | Description |
|----------|-----------|---|
| 1 | AM109 | Battery |
| | AM109CAP | Battery Caps |
| | SH0412C | Battery Terminal Bolt (2) |
| | N04C | Battery Terminal Bolt Nut (2) |
| | AM300 | Battery Clamp (2) |
| | SR0420C | Battery Clamp Bolt |
| | N04C | Battery Clamp Bolt Nut |
| 2 | AM014 | Ignition Switch |
| | AM015 | Ignition Key |
| 3 | AM159 | Solenoid |
| | SH0412C | Solenoid Mounting Bolt (2) |
| | N04CN | Solenoid Mounting Bolt Nut (2) |
| 4 | 091417L8 | Switch Socket include Loom NLA |
| | AM096 | Loom Clamp (3) |
| | PR0308 | Loom Clamp Pop Rivet (3) |
| | SAM104 | Fuse NLA |
| 5 | SAM189 | Lead Alternator to Battery Red via Solenoid NLA |
| | S091416L8 | Lead (Honda Only) Alternator to Battery via Solenoid NLA |
| 6 | SAM188 | Lead Switch Terminal (Mag) to Engine Cut Out Switch NLA |
| 7 | 13115 | Lead - Battery to Solenoid - Red |
| | 13115 | Lead - Solenoid to Starter - Red |
| | AM265 | Lead (Tecumseh Only) Solenoid |
| 8 | 13116 | Lead - Solenoid Attaching Bolt to Battery Negative - Black |
| 9 | 13116 | Lead - Solenoid Attaching Bolt to Engine Cowl - Black |
| | SAM099 | Front Micro Bracket NLA |
| | SH0412C | Front Micro Bracket Bolt (2) |
| | N04CN | Front Micro Bracket Bolt Nut (2) |
| 10 | AM092 | Micro Switch (2) |
| | AM100R2 | Foot Micro Spring Plate |
| | SH0412C | Foot Micro Spring Plate Bolt (2) |
| | N04CN | Foot Micro Spring Plate Bolt Nut (2) |
| | SH0412C | Foot Micro Spring Plate Stop Bolt |
| | N04CN | Foot Micro Spring Plate Nut |
| | N04C | Foot Micro Spring Plate Lock Nut |
| 11 | S091408 | Lead-Switch Terminal (Grd) Earth via Engine Cowl NLA |
| | AM098M8 | Battery Cover |
| | 091425H6 | Seat Micro Bracket NLA |
| | SH0412C | Seat Micro Bracket Bolt |
| | N04CN | Seat Micro Bracket Bolt Nut |
| 12 | S091426J6 | Lead - Ground Switch to Micro Att Bolt NLA |
| 13 | S091427J6 | Lead - Seat Micro to Cutter Disengaging Micro NLA |
| 14 | S091428J6 | Lead - Disengaging Micro to Engine Cut Out Switch NLA |

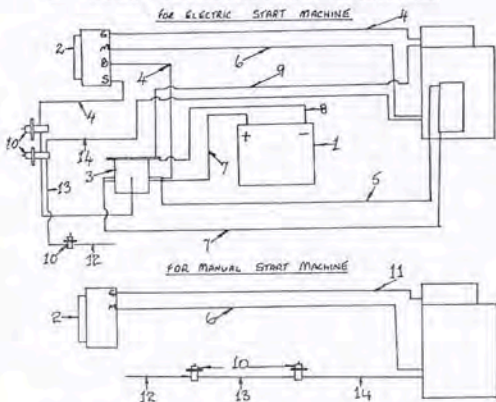

09F3 - 09B6 - 09J6 - 09M7 GROUP 15: STEERING COMPONENTS

| Ref. No. | Part No. | Description |
|----------|-----------|--|
| 1 | AM016 ** | Steering Wheel 09F3 NLA |
| | SKIT37 | Steering Wheel 09B6 09J6 09M7 |
| 3 | N06CN | Steering Wheel Nut |
| 4 | W061216 | Steering Wheel Nut Washer |
| 5 | S091502A9 | Steering Shaft NLA |
| 6 | AM017C1 | Steering Shaft Bush |
| 7 | AM066 | Steering Shaft Lock Collar |
| 8 | SS0406W | Steering Shaft Lock Collar Set Screw |
| 9 | AM018 | Steering Chain Include Link |
| 10 | SAM019 | Connecting Link |
| 11 | 09150003 | Steering Chain Adjuster NLA |
| 12 | SH0512C | Steering Chain Adjuster Bolt |
| 13 | W051216 | Steering Chain Adjuster Washer |
| 14 | N05CN | Steering Chain Adjuster Nut |
| 15 | AM046 | Steering Tie Rod Pivot Block |
| 16 | W061216 | Steering Tie Rod Pivot Block Washer |
| 17 | N06CN | Steering Tie Rod Pivot Bolt Nut |
| 18 | S091504F3 | Steering Idler Shaft |
| 19 | AM215 | Steering Idler Shaft Mtg Bracket Bush (2) |
| 20 | SAM214 | Steering Idler Shaft Mounting Bracket (2) NLA |
| 21 | SH0512C | Steering Idler Shaft Mtg Bracket Bolt (4) |
| 22 | W051216 | Steering Idler Shaft Mtg Bracket Washer (2) |
| 23 | W055 | Steering Idler Shaft Mtg Bracket S/p Washer (4) |
| 24 | S091507 | Bonnet Stop Bracket NLA |

**

Convert to SKIT37

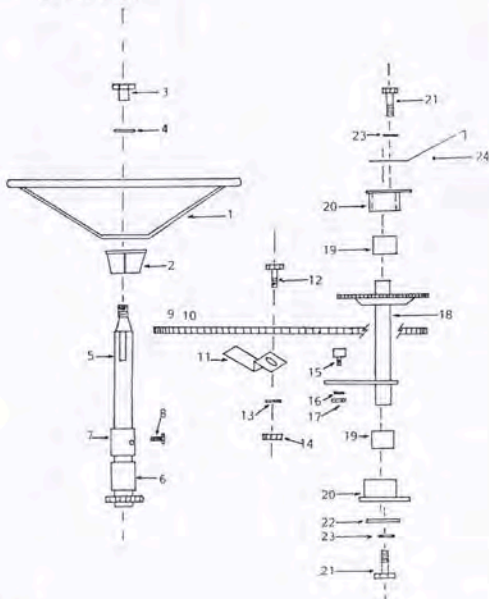

09F3 - 09B6 - 09J6 - 09M7 GROUP 16: FRONT AXLE COMPONENTS

| Ref. No. | Part No. | Description |
|----------|------------|-------------------------------------|
| 1 | KIT163 | Front Axle Beam UPDATE KIT |
| 2 | B1240W | Front Axle Pivot Bolt |
| 3 | SAM191 | Front Axle Pivot Bolt Nut |
| 4 | AM067 | Stub Axle LH |
| 5 | AM068 | Stub Axle RH |
| 6 | AM069 | Stub Axle Dust Cap (2) |
| 7 | CP3-225 | Stub Axle Split Pin (2) |
| 8 | GNTF3 | Stub Axle Grease Nipple (2) |
| 9 | NHM20X1.5T | Front Wheel Nut (2) |
| 10* | S091607F3 | Tie Rod NLA |
| 11* | W061216 | Tie Rod Pivot Bolt Washer (2) |
| 12* | N06CN | Tie Rod Pivot Bolt Nut |
| 13* | AM020 | Tie Rod End (2) |
| 14* | N06F | Tie Rod End Locknut (2) |
| 15* | B0620C | Tie Rod End Bolt (2) |
| 16* | N06CN | Tie Rod End Bolt Nut (2) |
| 17 | SAM192G3 | Front Axle Connecting Link |
| 18 | B0620C | Connecting Link Bolt (4) |
| 19 | N06CN | Connecting Link Bolt Nut (4) |
| 20 | AM03952 | Cutter Housing Pivot Rod NLA |
| 21 | RP02 | Cutter Housing Pivot Rod 'R' Pin |
| 22 | SKIT62R | Cutter Housing Connecting Link |
| 23 | AM040 | Cutter Belt Tension Spring (2) |
| 24 | AM145 | Weight Compensating Spring |

* Replace with SKIT04J97

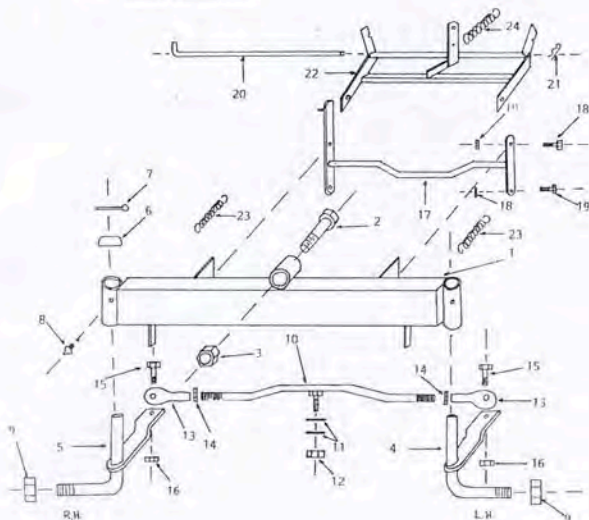

09F3 - 09B6 - 09J6 - 09M7 GROUP 17: FRONT WHEEL COMPONENTS

| Ref. No. | Part No. | Description |
|----------|-----------|--|
| 1 | TT500x6 | Front Wheel Tyre & Tube (Wide) (2) |
| | STY350x6 | Front Wheel Tyre (Std) (2) NLA |
| | STU500x6 | Front Wheel Tube (Wide) (2) |
| | STU350x6 | Front Wheel Tube (Std) (2) NLA |
| 3 | AM07099C | Front Wheel Hub Cap (2) |
| 4 | BB204212N | Front Wheel Bearing (4) |
| 5 | AM021 | Front Wheel Bearing Spacer (2) |
| | W203902 | Front Wheel Inner Dust Washer (2) |
| 6 | AM193M9 | Front Wheel Hub (One Piece) (Wide) (2) |
| | 091701 | Front Wheel Hub (Std) (2) NLA |
| | 091702 | Front Wheel Rim (Std) (2) NLA |
| | B0520C | Front Wheel Rim Retaining Bolt (6) |
| | N05C | Front Wheel Rim Retaining Bolt Nut (6) |

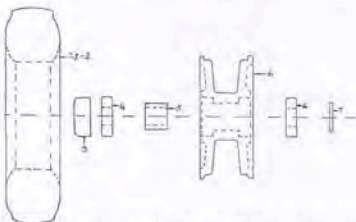

09F3 - 09B6 - 09J6 - 09M7 GROUP 18: REAR WHEEL COMPONENTS

| Ref. No. | Part No. | Description |
|----------|----------|---|
| 1 | TY400X8 | Rear Wheel Tyre (Std) (2) NLA |
| | STY650X8 | Rear Wheel Tyre & Tube (Wide) (2) |
| | STU400X8 | Rear Wheel Tube (Std) (2) NLA |
| | STU650X8 | Rear Wheel Tube (Wide) (2) |
| 3 | AM194 | Rear Wheel Hub (One Piece) (Wide) (2) |
| | 091801 | Rear Wheel Hub (Std) (Two Piece) (2) NLA |
| | S091802 | Rear Wheel Rim (Std) (Two Piece) (2) NLA |
| | B0632C | Rear Wheel Rim Std Retain Bolt (12) |
| | N06C | Rear Wheel Rim Std Retain Bolt Nut (12) |

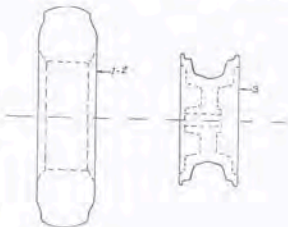

09F3 - 09B6 - 09J6 - 09M7 GROUP 19: DRIVE COMPONENTS

| Ref. No. | Part No. | Description |
|----------|-----------|--|
| 1 | AM018 | Drive Chain Include Conn Link |
| 2 | SAM019 | Drive Chain Connecting Link |
| | B0846W | Chain Adjuster Bolt |
| | W081816 | Chain Adjuster Bearing Washer (2) |
| | AM154 | Chain Adjuster Bearing Spacer |
| | SKIT31 | Chain Adjuster Bearing & Spacer |
| | SAM195 | Chain Adjuster Pillar |
| | AM196 | Chain Adjuster Lock Plate NLA |
| 9 | SAM071E95 | Intershaft |
| 10 | SAM022 | Intershaft Nut |
| 11 | SKIT30 | Intershaft Sprocket & Key |
| 12 | SK03 | Intershaft Sprocket Key |
| 13 | BB25SAN | Intershaft Bearing (2) |
| 14 | AM024 | Intershaft Bearing Flange (4) |
| 15 | SH0616C | Intershaft Bearing Flange Bolt (6) |
| 16 | W061216 | Intershaft Bearing Flange Bolt Washer (6) |
| 17 | N06CN | Intershaft Bearing Flange Bolt Nut (6) |
| 18 | AM025 | Intershaft Lock Collar (2) |
| 19 | GS0505C | Intershaft Lock Collar Set Screw (2) |
| 20 | AM197 | Clutch Plate (2) |
| 21 | S50612C | Clutch Plate Set Screw (4) |
| 22 | N06C | Clutch Plate Set Screw Locknut (4) NO LONGER USED |
| 23 | SAM198 | Rear Axle |
| 24 | N10F | Rear Axle Nut (2) |
| 25 | W102016 | Rear Axle Washer (2) |
| 26 | K18 | Rear Axle Key (2) |
| 27 | BB25SAN | Rear Axle Bearing (2) |
| 28 | AM024 | Rear Axle Bearing Flange (3) |
| 29 | SH0616C | Rear Axle Bearing Flange Bolt (3) |
| 30 | W061216 | Rear Axle Bearing Flange Bolt Washer (6) |
| 31 | N06CN | Rear Axle Bearing Flange Bolt Nut (6) |
| 32 | AM025 | Rear Axle Lock Collar (2) |
| 33 | GS0505C | Rear Axle Lock Collar Set Screw (2) |
| 34 | KIT16 | Drum Brake Band Include. Lining & Rivets |
| 35 | AM200 | Drum Brake Band Lining |
| 36 | PR0207 | Drum Brake Band Lining Rivet (4) |
| 37 | S091908F3 | Drum Brake Rod |
| 38 | CP3-220 | Drum Brake Rod Split Pin |
| 39 | N05CN | Drum Brake Rod Nut |
| 40 | AM202 | Rear Axle Bearing Flange LH NLA |

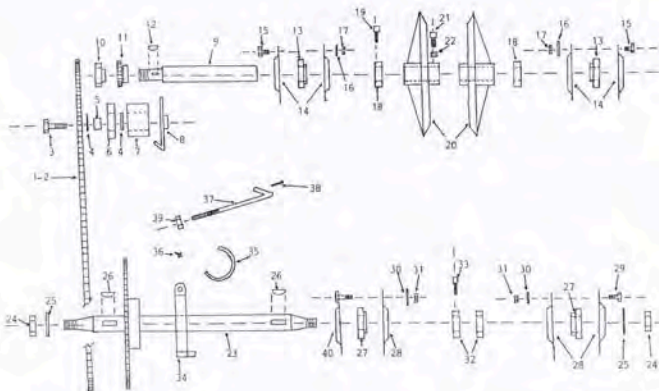

09F3 GROUP 20: CLUTCH ARM & COMPONENTS

| Ref. No. | Part No. | Description |
|----------|-----------|---------------------------------|
| 1 | SKIT22 | Clutch Arm NLA |
| 2 | AM204J3 | Clutch Shaft |
| 3 | W204303 | Clutch Cone Retaining Washer |
| 4 | CC2095G | Clutch Cone |
| 5 | AM026 | Clutch Cone Pin |
| 6 | AM158 | Clutch Pulley Upper |
| 7 | SK09 | Clutch Pulley Key |
| 8 | BB205215N | Clutch Bearing (2) |
| 9 | AM072 | Clutch Bearing Spacer |
| 10 | AM205 | Clutch Pulley Lower |
| 11 | B0648C | Clutch Arm Pivot Bolt |
| 12 | N06CN | Clutch Arm Pivot Bolt Nut |
| | 092006F3 | Clutch Tongue Saddle NLA |
| | B0416C | Saddle Bolt (2) |
| | N04CN | Saddle Bolt Nut (2) |
| 16 | SV14 | Belt - Engine to Clutch |

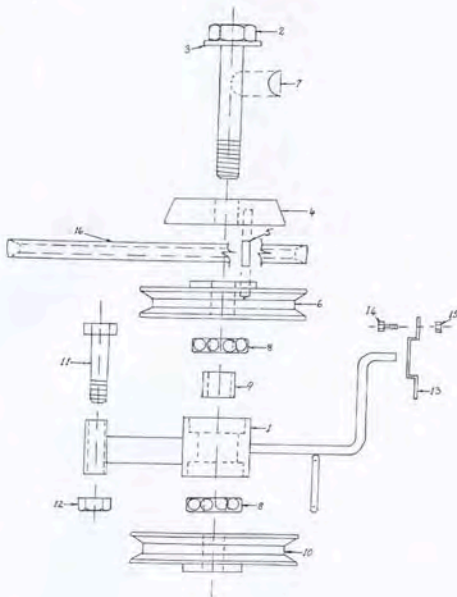

09B6 - 09J6 GROUP 20: CLUTCH ARM & COMPONENTS

| Ref. No. | Part No. | Description |
|----------|-----------|--|
| 1 | AM204J3 | Clutch Shaft |
| 2 | W204303 | Clutch Cone Retaining Washer |
| 3 | CC2095G | Clutch Cone |
| 4 | AM026 | Clutch Cone Pin |
| 5 | AM158 | Clutch Pulley Upper |
| 6 | SK09 | Clutch Pulley Key |
| 7 | BB205215N | Clutch Bearing (2) |
| 8 | AM072 | Clutch Bearing Spacer |
| 9 | AM205 | Clutch Pulley Lower |
| 10 | AM207 | Clutch Arm c/w Yoke |
| 11 | 092010B6 | Clutch Arm Yoke USE AM207 |
| 12 | SH0512C | Clutch Arm Yoke Retaining Bolt (2) |
| 14 | B0648C | Clutch Arm Pivot Bolt |
| 15 | N06CN | Clutch Arm Pivot Bolt Nut |
| 16 | AM206 | Clutch Arm Locating Bracket |
| 17 | SH0412C | Clutch Arm Locating Bracket Bolt (2) |
| 18 | N04CN | Clutch Arm Locating Bracket Bolt Nut (2) |
| 19 | AM246 | Clutch Arm Bracket Wear Plate |
| 20 | SH0512C | Clutch Arm Bracket Wear Plate Bolt (2) |
| 21 | W055 | Clutch Arm Bracket Wear Plate Washer (2) |
| 22 | SV14 | Belt - Engine to Clutch |

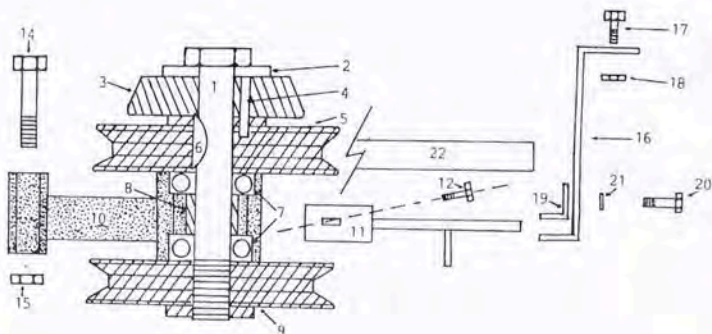

09M7 GROUP 20: CLUTCH ARM & COMPONENTS

| Ref. No. | Part No. | Description |
|----------|-----------|--|
| 1 | AM20413 | Clutch Shaft |
| 2 | W204303 | Clutch Cone Retaining Washer |
| 3 | CC2095G | Clutch Cone |
| 4 | AM026 | Clutch Cone Pin |
| 5 | AM158 | Clutch Pulley Upper |
| | W203902 | Clutch Pulley Bearing Washer |
| 6 | SK09 | Clutch Pulley Key |
| 7 | BB205215N | Clutch Bearing (2) |
| 8 | AM072 | Clutch Bearing Spacer |
| 9 | AM205 | Clutch Pulley Lower |
| 10 | AM207 | Clutch Arm c/w Yoke |
| 12 | SH0512C | Clutch Arm Yoke Retaining Bolt (2) |
| 14 | B0648C | Clutch Arm Pivot Bolt |
| 15 | N06CN | Clutch Arm Pivot Bolt Nut |
| 16 | AM206 | Clutch Arm Locating Bracket |
| 17 | SH0412C | Clutch Arm Locating Bracket Bolt (2) |
| 18 | N04CN | Clutch Arm Locating Bracket Bolt Nut (2) |
| 19 | AM246 | Clutch Arm Bracket Wear Plate |
| 20 | SH0512C | Clutch Arm Bracket Wear Plate Bolt (2) |
| 21 | W051216 | Clutch Arm Bracket Wear Plate Washer (2) |
| 22 | SV14 | Belt - Engine to Clutch |
| 23 | N05CN | Clutch Arm Wear Plate Nut (2) |
| 24 | AM208 | Clutch Adjusting Plate |
| 25 | AM209 | Clutch Adjusting Tapped Plate (2) |
| 26 | SH0616C | Adjusting Plate Bolt (2) |
| 27 | W06S | Bolt Lock Washer (2) |

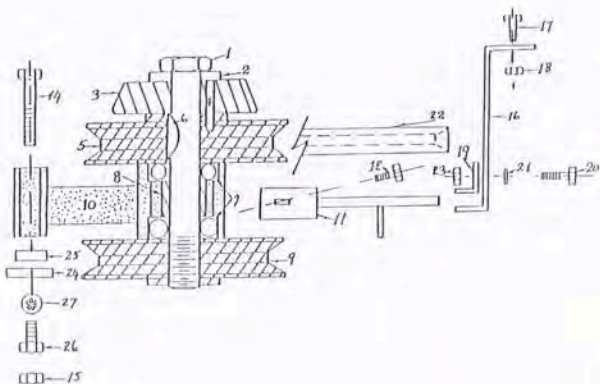

09F3 - 09B6 - 09J6 - 09M7

GROUP 21: 28" MOWING ATTACHMENT COMPONENTS

| Ref. No. | Part No. | Description |
|----------|------------|--|
| 1 | SKIT123 | Cutter Housing |
| 2 | AM259 | Deflector |
| | AM272 | Deflector Spring |
| 3 | AM273 | Deflector Rod |
| 4 | AM274 | Deflector Ratchet Plate |
| 5 | AM052E1 | Deflector Bracket |
| 6 | SH0412C | Deflector Bracket Bolt |
| 7 | N04CN | Deflector Bracket Bolt Nut (2) |
| 9 | STR09 | Transfer Cutter Housing LH NLA |
| 10 | STR10 | Transfer Cutter Housing RH |
| 11 | AM03609 | Cutter Housing Roller |
| 12 | AM037 | Cutter Roller Shaft |
| 13 | CP3-225 | Cutter Roller Shaft Split Pin |
| 14 | SKIT08 | Cutter Bearing Hsg c/w Belt Guides |
| 15 | AM073 | Belt Guides (2) |
| 16 | SH0625M | Belt Guide Bolt (2) |
| 17 | NM6NT | Belt Guide Bolt Nut (2) |
| 18 | B0620C | Cutter Bearing Housing Bolt (4) |
| 19 | NF06CN | Cutter Bearing Housing Bolt Nut (4) |
| 20 | 13181 | Cutter Shaft Incl Washer |
| | 13128 | Washer |
| 21 | SK09 | Cutter Shaft Key |
| 22 | BB205215N | Cutter Shaft Bearing (2) |
| 23 | AM029 | Bearing Spacer |
| 24 | AM030 | Cutter Shaft Pulley |
| 25 | W203902 | Pulley Ret. Washer (2) |
| 26 | NHM20x1.5T | Pulley Ret. Nut |
| 27 | KIT15 | Cutter Brake Incl. Pad |
| 28 | AM033195 | Cutter Brake Pad |
| 29 | PRO205 | Brake Pad Pop Rivet (2) |
| 30 | B0520C | Cutter Brake Pivot Bolt |
| 31 | N05CN | Cutter Brake Pivot Bolt Nut |
| 32 | AM07604A | Cutter Disc |
| 33 | SH0616C | Cutter Disc Ret. Set Screw (4) |
| 34 | N06CN | Cutter Disc Ret. Bolt Nut (4) |
| 35 | SMB1505HD | Cutter Blade - Stepped (pr) |
| | SMB150AHD | Cutter Blade - Air Flow (optional) (pr) |
| 36 | WM205 | Pulley Ret. Shakeproof Washer |
| 37 | SKIT01D1 | Blade Bolt & Nut Set |
| 43 | V07 | Belt - Cutter to Clutch 09F3 09M7 |
| | V08 | Belt - Cutter to Clutch 09B6 09J6 |
| 45 | AM220 | Cutter Front Guard |
| 46 | W051216 | Cutter Guard Washer (3) |
| 47 | N05CN | Cutter Guard Ret. Nut (3) |
| | AM074 | Cutter Bar NLA |
| | AM086 | Cutter Bar NLA |
| | AM081 | Cutter Bar Saddle Clamp NLA |
| | SH0616C | Saddle Clamp Ret Bolt (4) |
| | N06CN | Saddle Clamp Ret Bolt Nut (4) |

- *SKIT66 Deflector Kit
- SKIT32 Blade, Bolt, Nut Set - Stepped
- SKIT33 Blade, Bolt, Nut Set - Air Flow

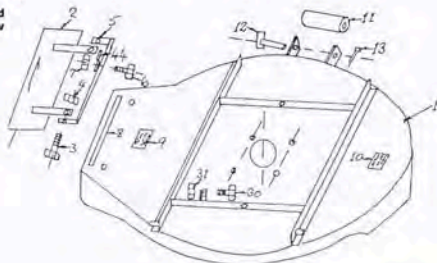
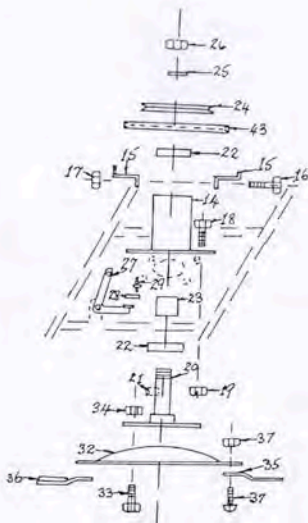

OPERATING & MAINTENANCE INSTRUCTIONS

IMPORTANT

When starting engine do not have foot resting on clutch pedal.

Keep feet and hands clear of mowing attachment when starting and operating machine.

Do not use mowing attachment with broken or bent blades or damaged cutter disc, otherwise damage may result from vibration. Replace blades only in pairs to maintain correct balance.

DO NOT USE WITHOUT WINDROWER

Check all bolts and nuts after first hour of running to ensure trouble free service and adjust engine to clutch belt. (Refer instructions.)

Mount and dismount only from left hand side of machine.

Reference to left or right side of machine is determined by sitting in the operating position on the machine.

TO OPERATE

BEFORE STARTING: See Engine Maintenance/Instruction Sheet.

DISENGAGING MOWING ATTACHMENT: The disengaging lever is situated on the right hand side by the steering column. Before starting, disengage mowing attachment by pulling lever fully to the operator. For safety precautions it is advisable at all times, other than when mowing, that the mowing attachment be kept in the disengaged position.

TO DRIVE FORWARD/REVERSE: Power is regulated by the throttle. Set throttle control to desired engine power. Press down on the forward section of the clutch pedal for forward movement or on the rear section of the clutch pedal for reverse. The amount of pressure can be used to control the speed, especially in heavier conditions.

MANOEUVRING: Owing to the clutch type action of the friction drive, it is possible to take the machine straight from forward to reverse and vice versa. This instant forward and reverse operation makes the machine very manoeuvrable and the sharpest turn can be negotiated easily and quickly.

TO BRAKE (ONLY WITH ENGINE RUNNING): The clutch may be used to stop the machine. If travelling forward push the pedal into reverse until machine stops, then bring the pedal back to neutral position or vice versa if travelling in reverse. The parking brake should only be used for storage, transportation and emergency stopping.

CUTTING HEIGHT ADJUSTMENT: The height adjustment lever is located on the left hand side of the machine and may be altered to suit varying conditions, while the machine is in motion.

NOTE: When mowing slopes, leave machine in forward drive when going downhill. The low gearing will prevent it from picking up excessive speed. If very steep it may be necessary to throttle back slightly.

MAINTENANCE INSTRUCTIONS

IT IS THE OWNERS RESPONSIBILITY TO ENSURE THAT ALL PERIODICAL CHECKS, NECESSARY ADJUSTMENTS AND SERVICES ARE CARRIED OUT.

STOP ENGINE – NEVER ATTEMPT ANY FORM OF SERVICE OR ADJUSTMENT WITH ENGINE RUNNING. MAKE SURE THE BLADES HAVE STOPPED ROTATING BEFORE CARRYING OUT ANY ADJUSTMENT.

1. OIL CHANGING (ENGINE): See engine maintenance/instructions sheet and carry out as per engine manufacturers recommendation.

2. LUBRICATION OF MACHINE: Lubrication of machine should be carried out every 25 hours of operation or once a month, whichever falls due first. Service engine and lubricate machine more frequently under adverse conditions.

A: Oiling — A few drops of oil should be placed at the following points:— Steering Column Shaft (top & bottom), Steering Linkages, Disengagement Linkages, Height Adjustment Mechanism, Pivot Bolt and linkages on Clutch Arm and Clutch Pedal.

B: Chain — Use chain lube only for lubricating the drive chain.

C: Grease Points — Grease nipples are located on the front wheel stub axle bushes.

UNDER NO CIRCUMSTANCES ALLOW GREASE OR OIL TO COME INTO CONTACT WITH THE CLUTCH CONE OR THE CLUTCH PLATE. SHOULD THIS OCCUR CLEAN OFF IMMEDIATELY WITH PETROL.

3. TO CHECK BLADES: Stop Engine. Remove spark plug lead. Lift windrower and put height adjustment control to highest position. If necessary simply remove the blade bolt and nut using a suitable spanner and replace worn parts.

4. CUTTER TO CLUTCH VEE BELT: Tension is automatically adjusted by the belt tensioning springs. However, as the belt stretches it will be necessary to lower the rear of the cutter housing by loosening the rear lifting link nut to level the cutter housing and vice versa when a new belt is fitted.

5. ENGINE TO CLUTCH VEE BELT ADJUSTMENT: Loosen the four engine mounting bolts. Move engine forward and adjust belt to correct tension. Re-tighten bolts.

6. DISENGAGING ADJUSTMENT: Disengagement handle in the engaged position, (with mowing attachment in middle cut position), is approximately parallel to foot rest angle. Due to normal wear in cutter to clutch vee belt, clearance will reduce. When clearance is reduced to zero, adjustment will be necessary to the disengagement adjuster and cutter head brake assembly. With the disengagement handle in the engaged position and mowing attachment in middle cut, remove 'R' pin and washer from disengagement adjuster, pull out adjuster from mounting pin. Screw adjuster in or out to give required clearance. Replace adjuster, washer and 'R' pin.

7. CUTTER BRAKE ASSEMBLY ADJUSTMENT: With disengagement handle in engaged position and mowing attachment in middle cut, normal clearance between cutter head pulley and cutter head brake pad is approximately 1/8" (3mm). To adjust clearance, remove 'R' pin from brake pull rod where it attaches to the chassis. Adjust to give required clearance, replace brake pull rod and 'R' pin. Check operation after adjustment.

8. CLUTCH PLATE ADJUSTMENT: Periodically it will be found necessary to adjust the clutch plates as the clutch cone wears. To carry out this operation, first loosen the lock nuts and set screws holding the plates in position. Position the clutch plate in neutral centre position. This in turn positions the clutch cone in neutral. Slide the reverse (L) clutch plate over to touch the clutch cone and tighten the set screw. Move the forward (R) plate until approximately 1/32" (.8mm) from the clutch cone. Tighten the set screws and lock nuts. A good check on the neutral position of the clutch arm is to make sure both plates are moved an equal amount.

9. DRIVE CHAIN: Loosen bolt through chain tensioner (Bearing). Move tensioner into chain (finger tight pressure only). Retighten bolt. There should be no backlash on chain.

10. TO ADJUST STEERING CHAIN: Loosen bolt holding the adjuster and support bracket. Push bracket in tight on chain being careful that quadrant portion presses on the chain rollers. Re-tighten bolt and test steering.

11. TO REMOVE MOWING ATTACHMENT: Remove weight compensating spring. Remove 'R' pins from front pivot rod, rear lifting link and cutter brake adjusting rod. Remove rear lifting link from mowing attachment and cutter brake rod from chassis, raising mowing attachment to mid-height position, disengage mowing attachment, remove belt, remove pivot rod. Tilt machine toward left hand side and slide attachment from under machine. To refit, reverse the above.

12. TYRE PRESSURE: 20 P.S.I. (140kPa) approximately front and rear. Uneven pressures can give an uneven finish when mowing and may cause damage to tyres and tubes.

13. BATTERY MAINTENANCE: Maintain electrolyte fluid level just above plates by topping regularly with distilled water. On machines fitted with Dunlop Pulsar Battery no maintenance is required as this is a completely sealed battery.

14. GENUINE SPARE PARTS: Always use genuine COX factory made spare parts. Use of non-genuine COX spares will void your warranty.

15. SAFETY FIRST: The use of any mechanical appliance can cause injury if incorrect procedures are used.

**WE ARE PROUD THAT YOU HAVE PURCHASED THIS UNIT AND WANT YOU TO HAVE THE BEST FROM IT.
IF IN DOUBT CHECK WITH YOUR SUPPLIER, OR PHONE US DIRECT ON (07) 391 2841.**